



**2050 S. BASCOM AVE.
CAMPBELL,
CALIFORNIA**

**PRIME CAMPBELL RETAIL/OFFICE
NEAR THE PRUNEYARD**



PROPERTY HIGHLIGHTS:

- 2,400± SF Available
- 40 Ft. Glass Storefront
- Asking \$2.95 PSF, NNN
- Low NNNs
- 100 AMPS
- Excellent Parking
- Signage On Bascom Ave.
- Near The Pruneyard & the Intersection of Campbell Ave. and Bascom Ave.

ESTIMATED DEMOGRAPHICS:

	<u>1 MILE</u>	<u>3 MILES</u>	<u>5 MILES</u>
POPULATION	24,434	226,627	549,418
AVG. HH INCOME:	\$ 97,782	\$101,566	\$104,844

FOR MORE INFORMATION CONTACT:

MEACHAM/OPPENHEIMER, INC.
CORFAC INTERNATIONAL
8 No. San Pedro St., Suite 300
San Jose, California 95110
Tel: 408.378.5900
Fax: 408.378.5903
www.moinc.net

Keon Vossoughi
Lic# 01019117
keon@moinc.net
(408) 477-2515
(408) 378-5900

David Taxin
Lic. #0983163
dtaxin@moinc.net
(408)477-2508

2050 S. Bascom Avenue • Campbell, California

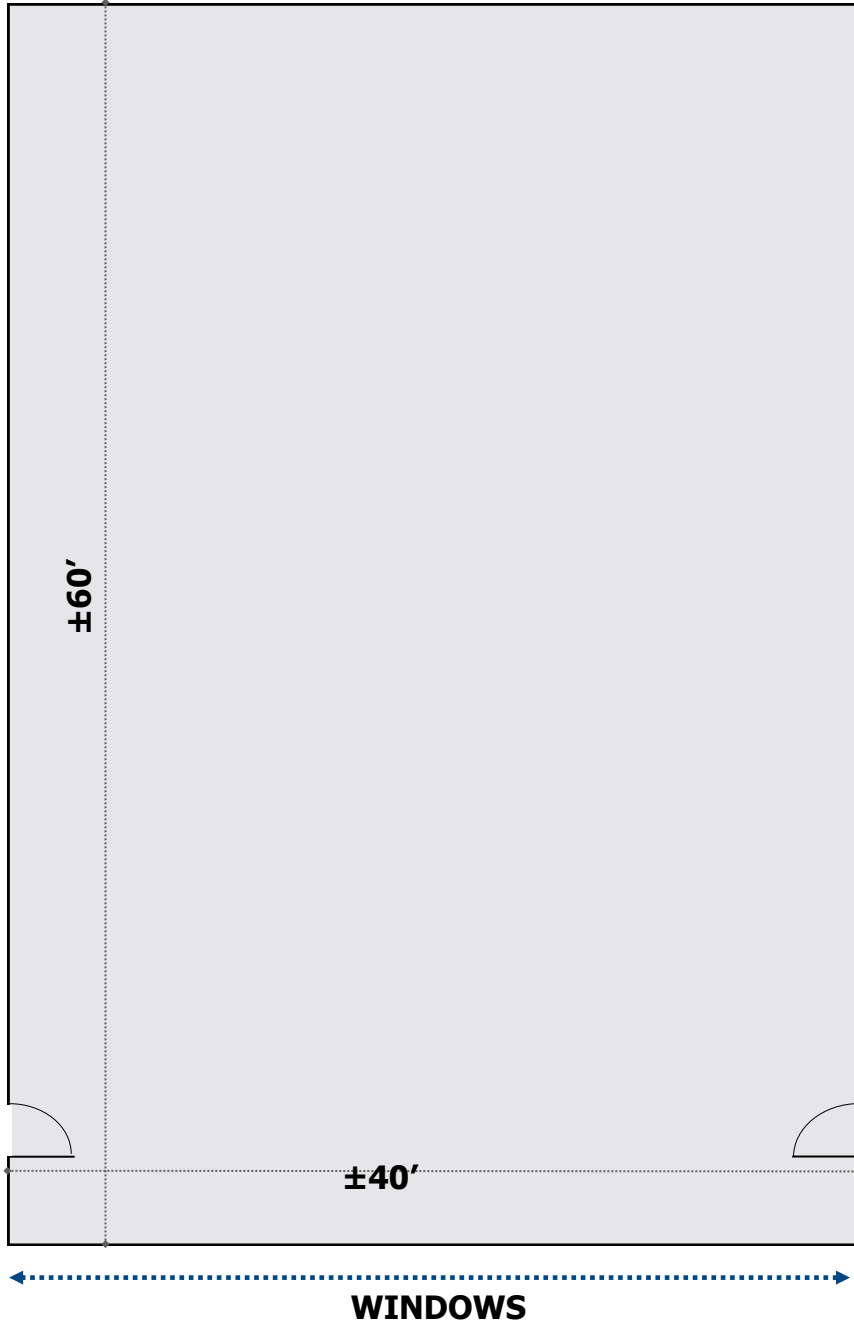

MEACHAM/OPPENHEIMER, INC.
CORFAC INTERNATIONAL
8 No. San Pedro St., Suite 300
San Jose, California 95110
Tel: 408.378.5900
www.moinc.net

Keon Vossoughi
Lic# 01019117
keon@moinc.net
(408) 477-2515
(408) 378-5900

David Taxin
Lic. #0983163
dtaxin@moinc.net
(408)477-2508

2050 S. Bascom Avenue • Campbell, California



MEACHAM/OPPENHEIMER, INC.
CORFAC INTERNATIONAL
8 No. San Pedro St., Suite 300
San Jose, California 95110
Tel: 408.378.5900
www.moinc.net

Keon Vossoughi
Lic# 01019117
keon@moinc.net
(408) 477-2515
(408) 378-5900

David Taxin
Lic. #0983163
dtaxin@moinc.net
(408)477-2508