

RETAIL SPACE FOR LEASE - 222 BROADWAY, OAKLAND, CA

JOIN STARBUCKS AT THE ELLINGTON

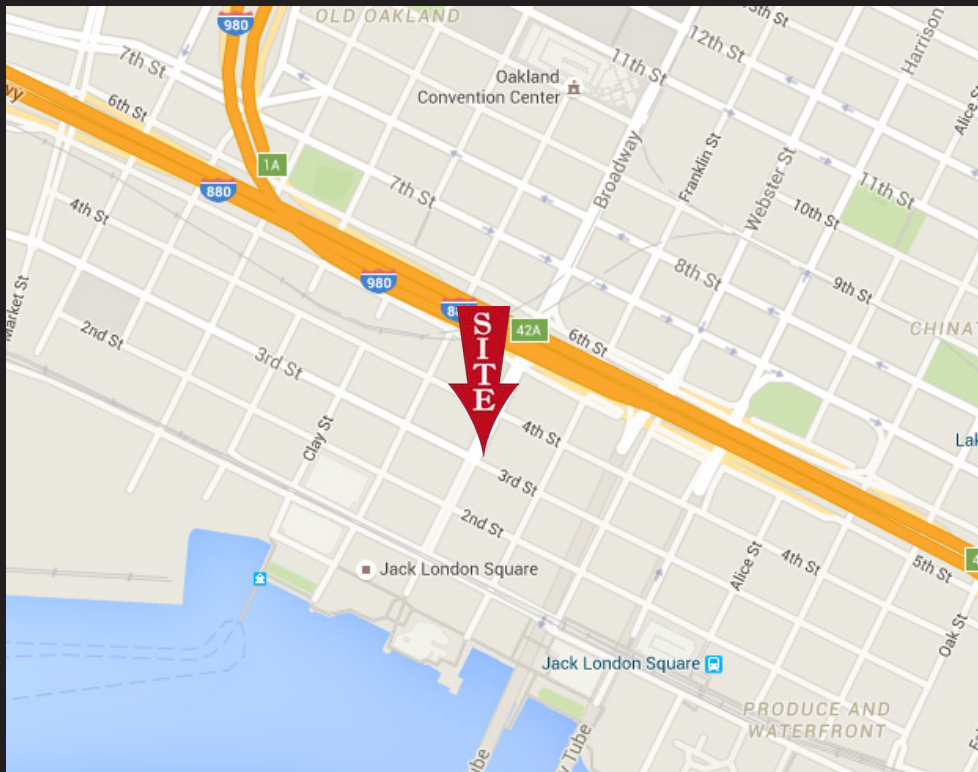

LOCKEHOUSE



HIGHLIGHTS

- ◆ Starbucks Open Now!
- ◆ Currently 5,000 Dwelling Units in Walking Distance within Jack London Square
- ◆ - With an Additional 1,000 Dwelling Units Approved for Development
- ◆ 20' Ceiling Heights
- ◆ Dedicated Parking in Covered Garage
- ◆ Easy Access and Visibility
- ◆ Close Proximity to Highway 880 and Interstate 80

PROPERTY SUMMARY

- ◆ Residential Units: 134 (Units sell for approximately \$1,000 PSF)
- ◆ Available GLA: 4,900 SF
- ◆ Total GLA: 9,115 SF

DEMOGRAPHICS

	1 Mile	3 Miles	5 Miles
Population	28,192	236,465	473,669
AHHI	\$66,697	\$85,157	\$99,127
Daytime population	56,484	148,338	225,391

THE ABOVE INFORMATION, WHILE NOT GUARANTEED, HAS BEEN SECURED FROM SOURCES WE BELIEVE TO BE RELIABLE. SUBMITTED SUBJECT TO ERROR, CHANGE OR WITHDRAWAL. AN INTERESTED PARTY SHOULD VERIFY THE STATUS OF THE PROPERTY AND THE INFORMATION HEREIN.

Broadway Street

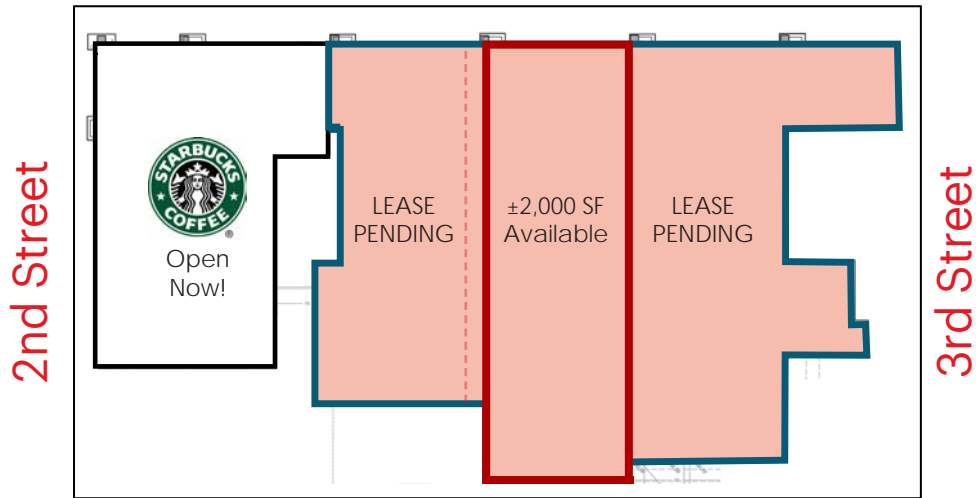

The Ellington is known as Jack London's premier mixed-used building comprised of 134 residential units with 9,115 square feet of street level retail. Located at the south end of Broadway, this property sits at the entrance of Jack London Square, a popular entertainment and business destination on the waterfront of Oakland.



- JACK LONDON square
- WORLD MARKET
- WATERFRONT
- Forge
- in plank
- Lugonare
- SUBWAY
- Ystis
- BAIA PASTA
- Il Pescatore
- NATE'S Gift Shop
- CROSSFIT EASTBAY
- HEINOLDS FIRST AND LAST GRAVIES
- visit OAKLAND
- Bay Country
- BEN & JERRY'S
- Bay Trail
- miette
- BAY AREA BIKES
- JACK'S OYSTER BAR & FISH HOUSE
- KINCAID'S
- STEEL ORAIL
- SOFF'S
- ROSENBLUM VELLARS
- HAVEN
- BevMo!
- BOCANOVA
- CALIFORNIA GANDE-KAYAK



Planned Development
48 Market Rate
Apartment Units

WORLD MARKET
COST PLUS

PORT OF OAKLAND

REGAL ENTERTAINMENT GROUP

BED BATH & BEYOND

Yogi's

PORT

**THE ELLINGTON
222 BROADWAY**

BLUE BOTTLE COFFEE

BOCANOVA

HAVEN OAKLAND

FOODCRAFT INSTITUTE

Sunset

BevMo!

BELCAMPO MEAT CO.

JACK'S

eat real
(RESTAURANT)

Forge
HANDCRAFTED

Water Street Market

plank

miette PÂTISSERIE

WATERFRONT HOTEL

Lungomare



Jack London Under Construction

JACK LONDON OAKLAND

★ LISTING TEAM ★

Jon Woodcox

Retail Specialist | (650) 548-2675
jon@lockehouse.com | License #01923630

Siddhi Saraiya

Retail Specialist | (415) 960-5877
siddhi@lockehouse.com | License #02012635

Kurt Grundman

Partner | (415) 640-8779
kurt@lockehouse.com | License #01229064