



CORPORATE CENTRE FANNIN



FOR LEASE



Building A 10001 Fannin St. Suite 600 Houston, TX 77045

- » 27,318 SF available immediately
- » 1,850 SF office space
- » 100% HVAC warehouse
- » ESFR sprinkler system
- » 30' clear height
- » 4 dock high & 1 grade level ramp
- » Convenient access to 610 Loop and Hwy 288 via Almeda Rd or Fannin St
- » Strategic last mile location
- » 2 miles from Texas Medical Center

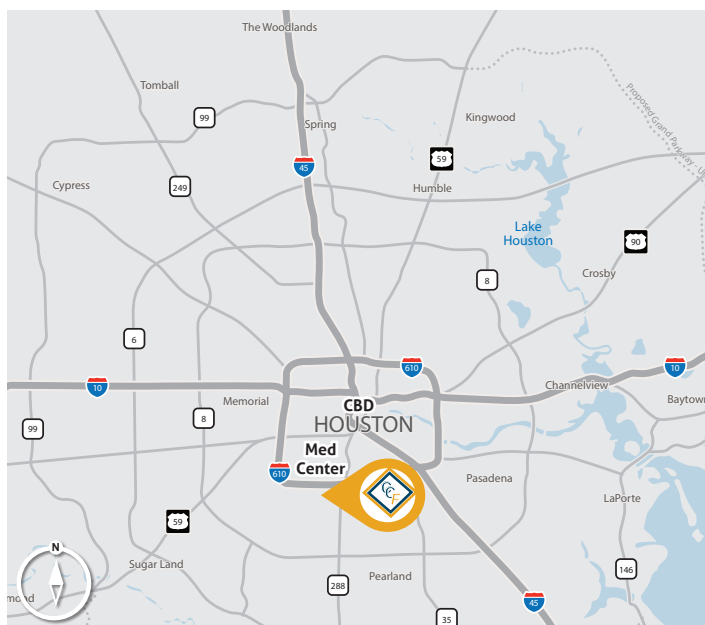



CORPORATE CENTRE FANNIN

AVAILABLE FOR LEASE 27,318 SF WAREHOUSE
10001 FANNIN STREET, SUITE 600
HOUSTON, TEXAS 77045



BUILDING AREA = 27,318 SF

OFFICE SPACE = 1,850 SF

CLEAR HEIGHT = 30'

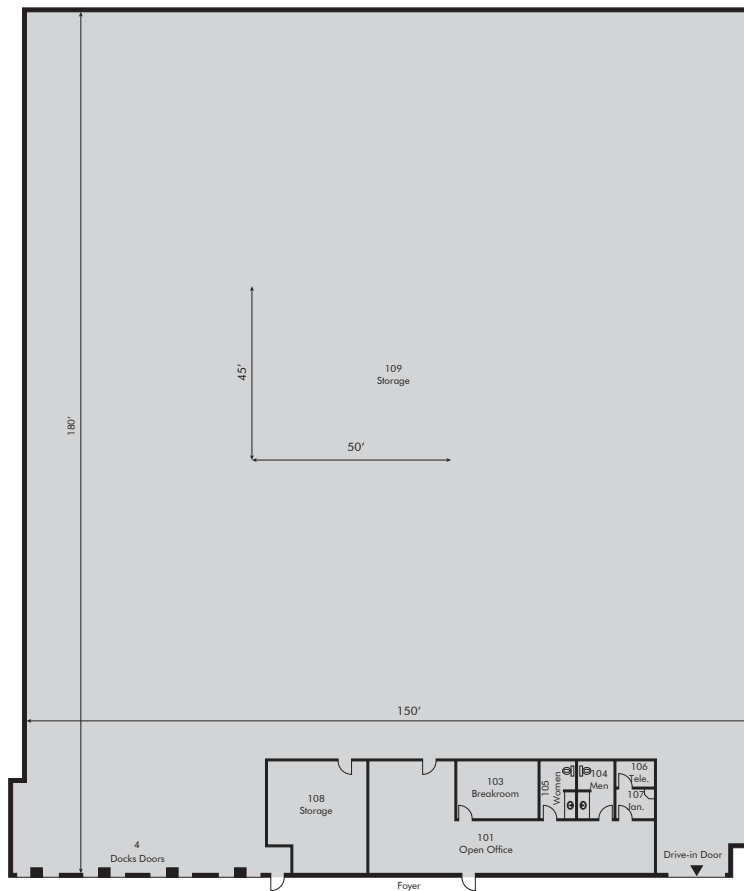

FARON WILEY

713 577 1839 | faron.wiley@cbre.com

BILLY GOLD

713 577 1709 | billy.gold@cbre.com

DAVID HUDDLESTON

713 577 1540 | david.huddleston@cbre.com

© 2019 CBRE, Inc. This information has been obtained from sources believed reliable. We have not verified it and make no guarantee, warranty or representation about it. Any projections, opinions, assumptions or estimates used are for example only and do not represent the current or future performance of the property. You and your advisors should conduct a careful, independent investigation of the property to determine to your satisfaction the suitability of the property for your needs. Photos herein are the property of their respective owners and use of these images without the express written consent of the owner is prohibited. CBRE and the CBRE logo are service marks of CBRE, Inc. and/or its affiliated or related companies in the United States and other countries. All other marks displayed on this document are the property of their respective owners.

