

High quality office accommodation



TO LET

Suites from 3,815 sq ft (454.44 sq m)

Westpoint Business Park Junction 28, Glasgow Airport, Paisley PA3 2RB

Striking double height entrance to bright, open-plan office space

Specification

- 'Very Good' BREEAM Rating
- B+ EPC Rating
- Distinctive design with striking, double height entrances
- Open plan, efficient office floor plates
- Fully accessible raised access flooring with minimum 120mm clear void
- Suspended ceiling incorporating LG 7 compatible lighting
- 2.9m clear floor to ceiling height
- Gas fired central heating
- Double glazing with opening windows
- Ability to fit comfort cooling
- 13 person passenger lift
- Dedicated male, female and disabled toilets on each floor
- Shower facilities
- Cycle racks
- DDA Compliant
- 48 car spaces
- Overspill car parking available



Schedule of accommodation and floor plans



Suites from
3,815 sq ft (454.44 sq m)

| Floor | Sq ft | Sq m |
|--------------|---------------------------------------|-----------------|
| Second | Let to Balfour Beatty | |
| First North | 3,988 | 370.45 |
| First South | Let to Maritime and Coastguard Agency | |
| First Total | 3,988 | 370.45 |
| Ground North | 3,815 | 354.44 |
| Ground South | 4,689 | 435.66 |
| Ground Total | 8,504 | 790.10 |
| TOTAL | 12,492 | 1,160.55 |

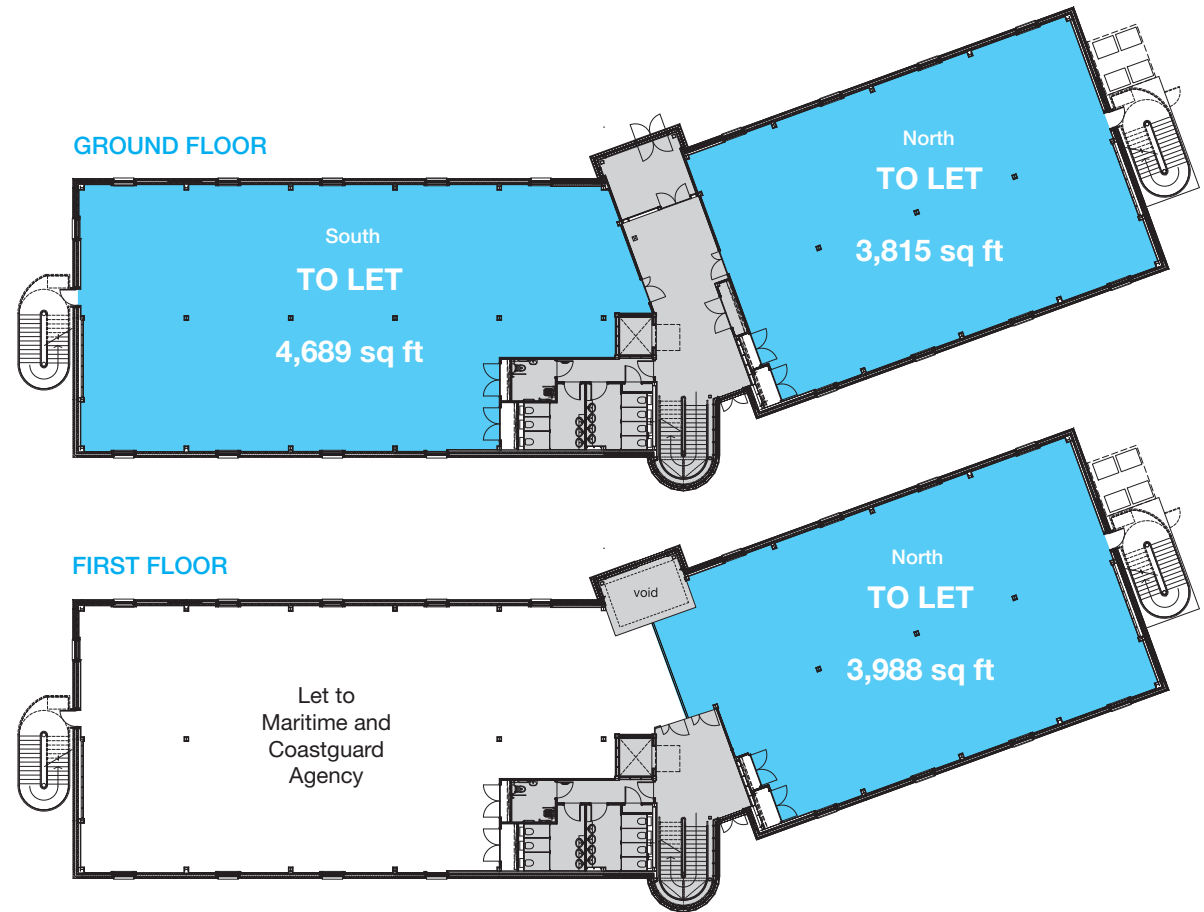

Westpoint Business Park is strategically located with direct access to Junction 28 of the M8 motorway linking through to the M80/M9 (North), M74 (South), and M77 (Ayrshire).



Road

Just off Junction 28, M8 (Glasgow International Airport), 15 minutes drive to the west of Glasgow City Centre. Inchinnan Road is the main route from the Airport to Paisley Town Centre.

Bus

Direct express bus services run regularly to and from the Airport and Glasgow City Centre.

Local bus services run along Inchinnan Road every few minutes between the Airport and Paisley Town Centre connecting to Paisley Gilmour Street mainline railway station, providing an excellent service for staff commuting to work, shops or leisure.

A bus stop is located on Inchinnan Road, adjacent to the Park.

Train

Trains run through Paisley Gilmour Street linking Ayrshire and the west to Glasgow Central Station every 7 minutes, providing excellent frequency of service and easy commuter access.

Airport

Glasgow International Airport is within a few minutes bus/taxi ride or walk. The Airport provides a wide range of frequent scheduled flights to London and other UK and International destinations.

On the instructions of
Clowes Developments (Cart Corridor) Limited



For further information
please contact letting agents

CBRE
0141 204 7666
www.cbre.co.uk

Alistair Urquhart
DDI 0141 204 7756

Ryden.co.uk
0141 204 3838

Tim Jacobsen
DDI 0141 270 3170