

FOR LEASE: 22,000 SQUARE FEET

8130 JOHN W CARPENTER FWY, DALLAS, TX 75247

INDUSTRIAL REAL ESTATE BROKERAGE

WWW.MERCER-COMPANY.COM

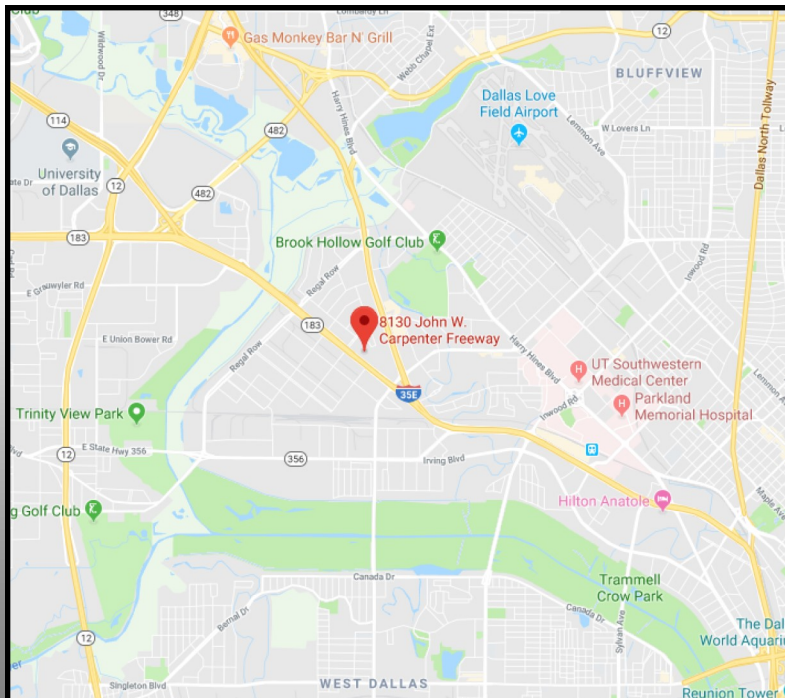
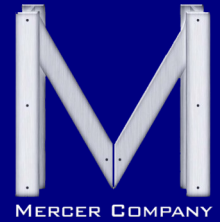

DETAILS

AVAILABLE FOR LEASE

- ◆ TOTAL SF: 22,000
- ◆ OFFICE SF: 22,000
- ◆ LAND AREA: 1.74 ACRES
- ◆ 100% HVAC
- ◆ SPRINKLERED
- ◆ PARKING: 4.24 / 1,000 SF
- ◆ FRONTAGE ON MAJOR FREEWAY

SINGLE STORY OFFICE JUST 5 MINUTES FROM DALLAS LOVE FIELD & ONLY 6 MILES FROM THE HEART OF DOWNTOWN DALLAS

JEREMY MERCER
CELL 214.682.3447
JEREMY@MERCER-COMPANY.COM

TURNER PETERSEN
CELL 214.906.4220
TPETERSEN@MERCER-COMPANY.COM

FOR LEASE: 22,000 SQUARE FEET

8130 JOHN W CARPENTER FWY, DALLAS, TX 75247

INDUSTRIAL REAL ESTATE BROKERAGE

WWW.MERCER-COMPANY.COM

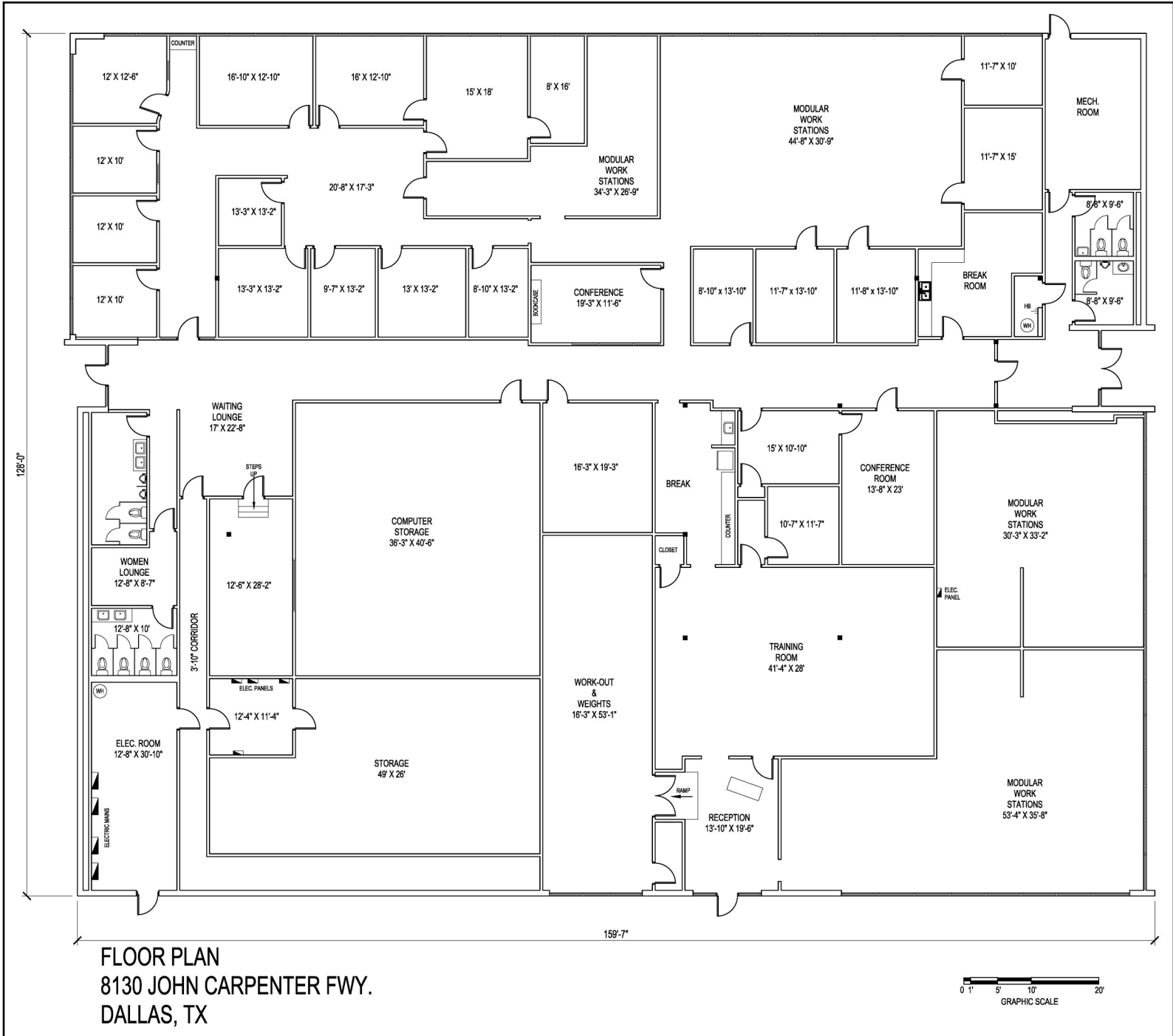
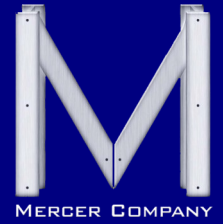

FLOOR PLAN
8130 JOHN CARPENTER FWY.
DALLAS, TX

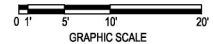

The information contained herein has been given to us by the owner of the property or other sources we deem reliable. We have no reason to doubt its accuracy, but we do not guarantee it. All information should be verified before purchase or lease.