

DOOR SCHEDULE					
#	ROOM NAME	FRAME TYPE	DOOR TYPE	SIZE	NOTE
B-01	STAIR	EXIST	EXIST HPL 4 FR	EXIST	EXISTING (INCLUDES CLOSER)
B-02	UTILITY RM	EXIST	EXIST HPL 4 FR	EXIST	EXISTING
B-03	ELEV. EQUIP.	EXIST	EXIST HPL 4 FR	EXIST	EXISTING
B-04	STAIR	EXIST	EXIST HPL 4 FR	EXIST	EXISTING (INCLUDES CLOSER)
---	---	---	---	---	---
L1-100	STAIR 100	EXIST	EXIST	3'-0" x 7'-0"	EXISTING ALUM. STOREFRONT DOOR AND FRAME
L1-101	STAIR 100	HPL	HPL	3'-0" x 7'-0"	20 MIN. RATING ASSEMBLY, LEVER, OH CLOSER, 1 1/2 PR HINGES, CLASSROOM LOCK
L1-102	CORRIDOR	EXIST	EXIST	3'-0" x 7'-0"	EXISTING - VERIFY SPOKE GASKETING
L1-103	TENANT 101	EXIST	EXIST	3'-0" x 7'-0"	EXISTING ALUM. STOREFRONT DOOR AND FRAME
L1-104	TENANT 101	ALUM	GL / ALUM	3'-0" x 7'-0"	PULL/PUSH BAR, OH CLOSER, LOCK WITH EXIT PADDLE, 1 1/2 PR HINGES, WEATHERSEAL
L1-105	TENANT 102	ALUM	GL / ALUM	3'-0" x 7'-0"	PULL/PUSH BAR, OH CLOSER, LOCK WITH EXIT PADDLE, 1 1/2 PR HINGES, WEATHERSEAL
L1-106A	VESTIBULE	ALUM	GL / ALUM	(DBL) 3'-0" x 7'-0"	PULL KEY LOCK, PANIC BAR, COORDINATOR, OH CLOSERS, 3 PR HINGES, WEATHERSEAL
L1-106B	VESTIBULE	ALUM	GL / ALUM	(DBL) 3'-0" x 7'-0"	PULL KEY LOCK, PANIC BAR, COORDINATOR, OH CLOSERS, 3 PR HINGES, WEATHERSEAL
L1-107	STAIR 104	EXIST	EXIST	3'-0" x 7'-0"	EXIST HPL DOOR AND FRAME WITH EXIT HARDWARE
L1-108	BOILER RM	EXIST	EXIST	3'-0" x 7'-0"	EXIST HPL DOOR AND FRAME AND HARDWARE
L1-109	STAIR 104	HPL	HPL	3'-0" x 7'-0"	20 MIN. RATING ASSEMBLY, LEVER, OH CLOSER, 1 1/2 PR HINGES, CLASSROOM LOCK
---	---	---	---	---	---
L3-200	WOMEN	HPL	HPL	3'-0" x 7'-0"	PUSH PLATE, FULL HANDLE, KICK PLATE, OH CLOSER, 1 1/2 PR HINGES, WALLSTOP
L3-201	MEN	HPL	HPL	3'-0" x 7'-0"	PUSH PLATE, FULL HANDLE, KICK PLATE, OH CLOSER, 1 1/2 PR HINGES, WALLSTOP
L3-202	UTILITY	HPL	HPL	3'-0" x 7'-0"	LEVER LOCK, OH CLOSER, 1 1/2 PR HINGES, WALLSTOP
L3-203	STAIR 201	HPL	HPL	3'-0" x 7'-0"	20 MIN. RATING ASSEMBLY, LEVER, OH CLOSER, 1 1/2 PR HINGES, CLASSROOM LOCK
L3-204	CLOSET	EXIST	EXIST	EXIST	EXIST
L3-205	STAIR 206	HPL	HPL	3'-0" x 7'-0"	20 MIN. RATING ASSEMBLY, LEVER, OH CLOSER, 1 1/2 PR HINGES, CLASSROOM LOCK
---	---	---	---	---	---
L3-300	WOMEN	HPL	HPL	3'-0" x 7'-0"	PUSH PLATE, FULL HANDLE, KICK PLATE, OH CLOSER, 1 1/2 PR HINGES, WALLSTOP
L3-301	MEN	HPL	HPL	3'-0" x 7'-0"	PUSH PLATE, FULL HANDLE, KICK PLATE, OH CLOSER, 1 1/2 PR HINGES, WALLSTOP
L3-302	UTILITY	HPL	HPL	3'-0" x 7'-0"	LEVER LOCK, OH CLOSER, 1 1/2 PR HINGES, WALLSTOP
L3-303	STAIR 301	HPL	HPL	3'-0" x 7'-0"	20 MIN. RATING ASSEMBLY, LEVER, OH CLOSER, 1 1/2 PR HINGES, CLASSROOM LOCK
L3-304	STAIR 306	HPL	HPL	3'-0" x 7'-0"	20 MIN. RATING ASSEMBLY, LEVER, OH CLOSER, 1 1/2 PR HINGES, CLASSROOM LOCK
---	---	---	---	---	---

NOTE:
 VERIFICATION, RELOCATION AND MODIFICATIONS TO UTILITIES ARE TO BE IDENTIFIED IN ME/P DESIGN-BUILD SCOPE PRIOR TO WORK START.
 NO ARCHITECTURAL WORK IN BASEMENT LEVEL. EXISTING WALLS, FLOOR AND CEILING TO REMAIN AS IS.

SEE STRUCTURAL FOR NEW VESTIBULE AND COLUMN SUPPORT FOOTINGS AND SLAB.

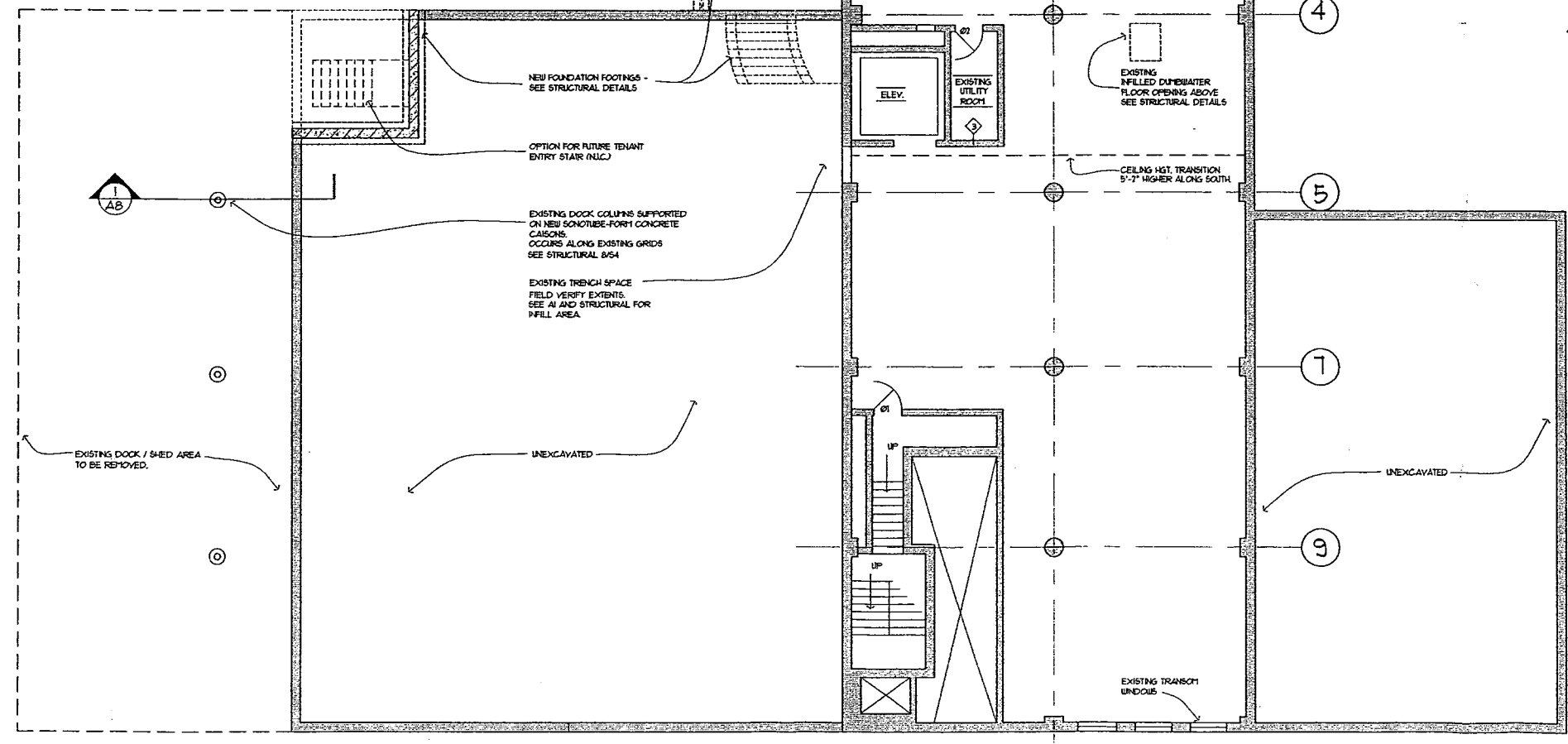

WALL KEY	
	DEMOLITION WALL
	EXISTING WALL CONSTRUCTION
	EXISTING 2" CMU OR BRICK INFILL WALL
	EXISTING 2" CMU OR BRICK WALL WITH LATH AND PLASTER INTERIOR FINISH LAYER
	8" FIRE-BLOCK MASONRY WALL (EXISTING)
	EXISTING 5" GYPSUM WALL ASSEMBLY
	5/8" GYP. TYPE "X" TAFED 4 SANDED WITH 3 5/8" STEEL STUDS 16" O.C. MAX WITH FIRE CALK FOR ULL 1-HR RATING
	FURRING / INFILL WALL FOR 1-HR RATING
	5/8" GYP. TYPE "X" TAFED 4 SANDED WITH 3 5/8" STEEL STUDS 16" O.C. MAX WITH 1/2" MFR. GYPSUM BOARD AT WET WALL LOCATIONS

basement plan

"fifth & wash"
 (formerly ppl bldg)

501 Washington Av. S.
 Minneapolis, MN

I hereby certify this plan, specification or report was prepared by me or under my direct supervision and that I am a duly registered architect under the laws of the state of Minnesota.

M. P. RASIS
 3/10/02

scale: 1/8" = 1'-0"
 job: 00-0000
 drawn: gsk/rh

1/27/02 13:25 1/27/02
 demo permit issue 9/30/02
 progress set 3/10/02

a - 0

1 BASEMENT FLOOR PLAN
 1/8" = 1'-0"

