

# FOR LEASE

## UNIVERSITY DISTRICT

### OFFICE/FLEX/SHOWROOM

## NEW OWNERSHIP

405/411/417 E PACIFIC AVENUE SPOKANE, WA 99202



- New Roof, Landscaping, Windows, and Exterior Lighting & Paint
- Flexible space suitable for wide range of uses
- Great University District location close to Downtown, Medical Schools, & Hospitals
- 2 Blocks from New University Gateway Bridge

- 34 Parking Stalls, plus ample street parking
- 2 Dock High Doors
- 3 Phase Power
- 9-10' Ceilings
- Zoning: GC-150
- Tenant Improvements Available

- Building Size: 12,456

405 E Pacific	Leased
411 E Pacific	3,000 SF
417 E Pacific	6,056 SF

LEASE RATE:

**\$12.00/SF/YR MODIFIED GROSS**

Tenant Pays Utilities & Janitorial



FOR INFORMATION: MIKE CRAVEN | 509-270-1141 | MIKE@CRAVENCOMPANY.COM

**Disclaimer:** No representation or warranty is expressed or implied by Craven Company, LLC or its affiliates as to the accuracy of the information contained herein. All information herein is furnished from sources deemed reliable. No one should rely solely on the information, but should conduct their own independent investigation. **Broker Disclosure:** Broker is also property owner.



GATEWAY BRIDGE  
FALL 2018

SUBJECT  
PROPERTY

405/411/417 E PACIFIC AVENUE  
SPOKANE, WA 99202



FOR INFORMATION: MIKE CRAVEN | 509-270-1141 | MIKE@CRAVENCOMPANY.COM

**Disclaimer:** No representation or warranty is expressed or implied by Craven Company, LLC or its affiliates as to the accuracy of the information contained herein. All information herein is furnished from sources deemed reliable. No one should rely solely on the information, but should conduct their own independent investigation. **Broker Disclosure:** Broker is also property owner.

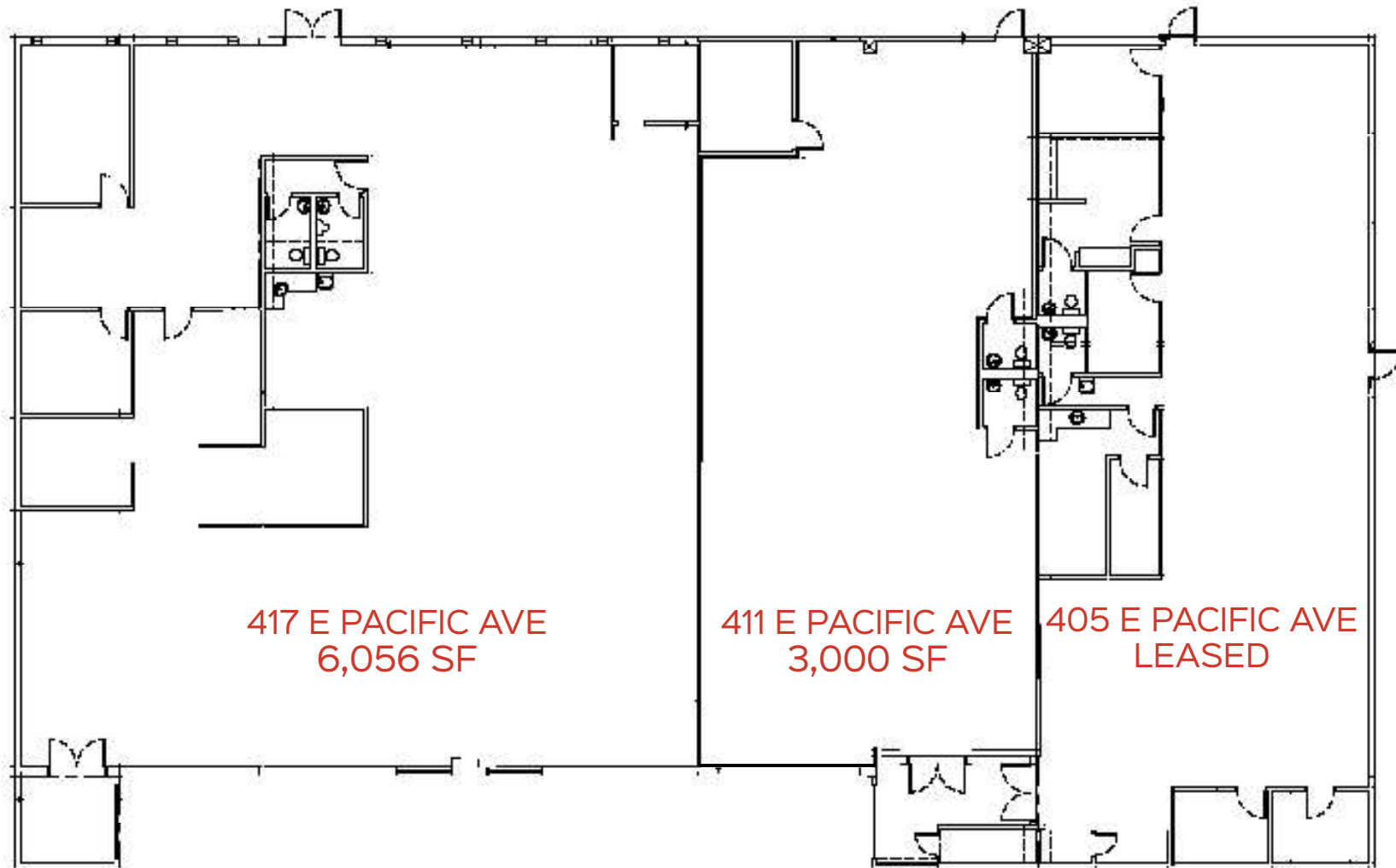

405/411/417 E PACIFIC AVENUE  
SPOKANE, WA 99202



FOR INFORMATION: MIKE CRAVEN | 509-270-1141 | MIKE@CRAVENCOMPANY.COM

**Disclaimer:** No representation or warranty is expressed or implied by Craven Company, LLC or its affiliates as to the accuracy of the information contained herein. All information herein is furnished from sources deemed reliable. No one should rely solely on the information, but should conduct their own independent investigation. **Broker Disclosure:** Broker is also property owner.