

# ±24,649 SF FOR LEASE

4020 NELSON AVENUE, SUITE 200 | CONCORD, CA



## PROPERTY HIGHLIGHTS

- » ±24,649 SF Available
- » Dimensions: ±159'3 D x ± 167'9 W
- » Concrete tilt-up construction
- » End cap unit
- » Rare dock-served opportunity in Concord
- » Close proximity to Hwy 4 & 680
- » Power: Approximately 400 amps @ 277/480 volts (to be verified)

## OFFICE FEATURES

- » ±3,600 SF (see floor plan next page)

## WAREHOUSE FEATURES

- » Five (5) dock-high doors
- » One (1) grade-level door, second possible with office demo
- » ±26'-28' clear height

## AVAILABILITY

- » Call brokers for more information
- » [View site specific COVID-19 plan](#)

**Tony Binswanger, SIOR**  
*Executive Director*  
+1 925 627 2482  
Tony.Binswanger@cushwake.com  
LIC#01861701

**Bo Harkins**  
*Director*  
+1 925 627 2481  
bo.harkins@cushwake.com  
LIC #01943785



# FLOOR PLAN

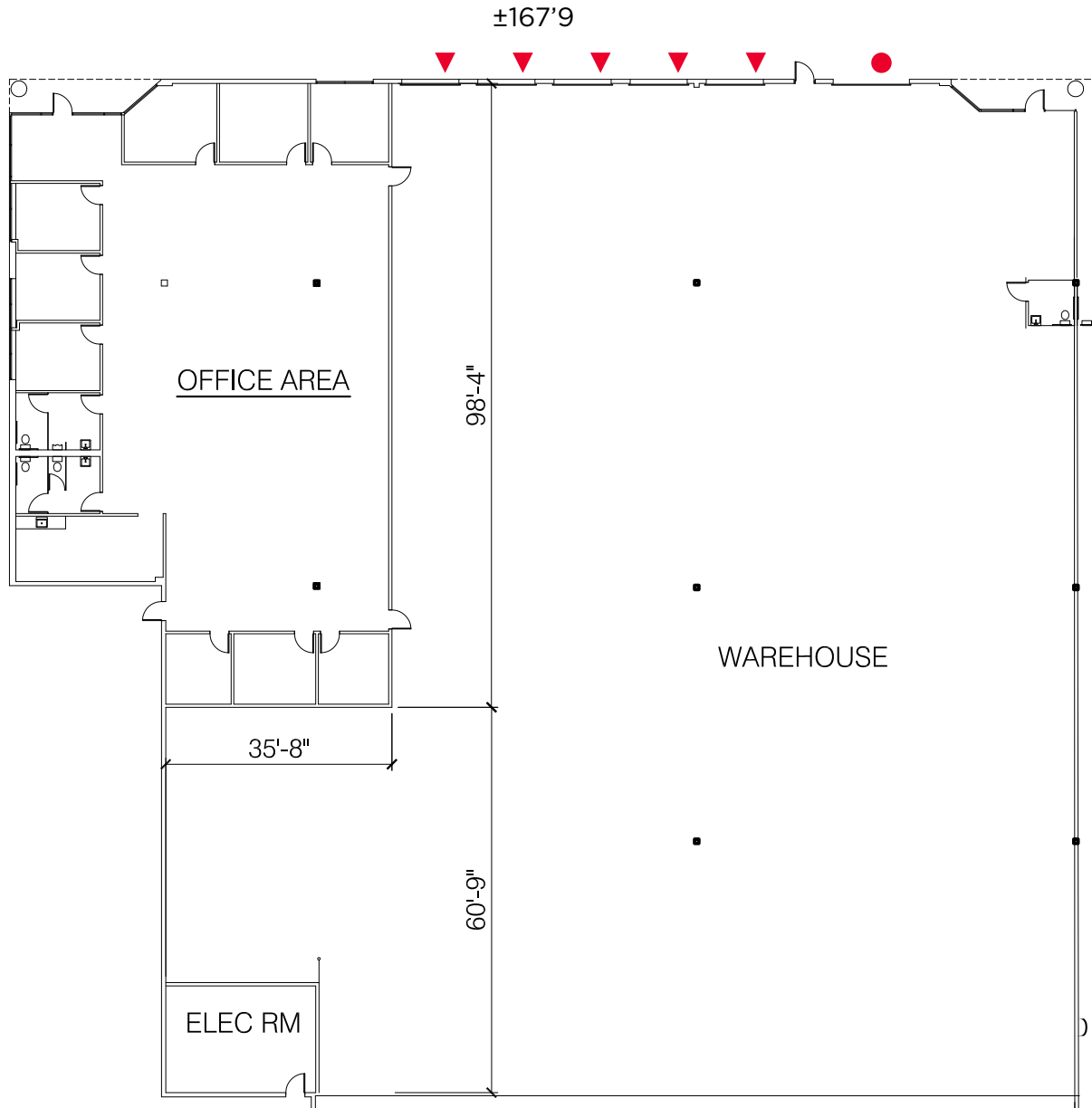

©2022 Cushman & Wakefield. All rights reserved. The information contained in this communication is strictly confidential. This information has been obtained from sources believed to be reliable but has not been verified. NO WARRANTY OR REPRESENTATION, EXPRESS OR IMPLIED, IS MADE AS TO THE CONDITION OF THE PROPERTY (OR PROPERTIES) REFERENCED HEREIN OR AS TO THE ACCURACY OR COMPLETENESS OF THE INFORMATION CONTAINED HEREIN, AND SAME IS SUBMITTED SUBJECT TO ERRORS, OMISSIONS, CHANGE OF PRICE, RENTAL OR OTHER CONDITIONS, WITHDRAWAL WITHOUT NOTICE, AND TO ANY SPECIAL LISTING CONDITIONS IMPOSED BY THE PROPERTY OWNER(S). ANY PROJECTIONS, OPINIONS OR ESTIMATES ARE SUBJECT TO UNCERTAINTY AND DO NOT SIGNIFY CURRENT OR FUTURE PROPERTY PERFORMANCE.

 **DOCK HIGH**  
 **GRADE-LEVEL**

**Tony Binswanger, SIOR**  
Executive Director  
+1 925 627 2482  
Tony.Binswanger@cushwake.com  
LIC#01861701

**Bo Harkins**  
Director  
+1 925 627 2481  
bo.harkins@cushwake.com  
LIC #01943785



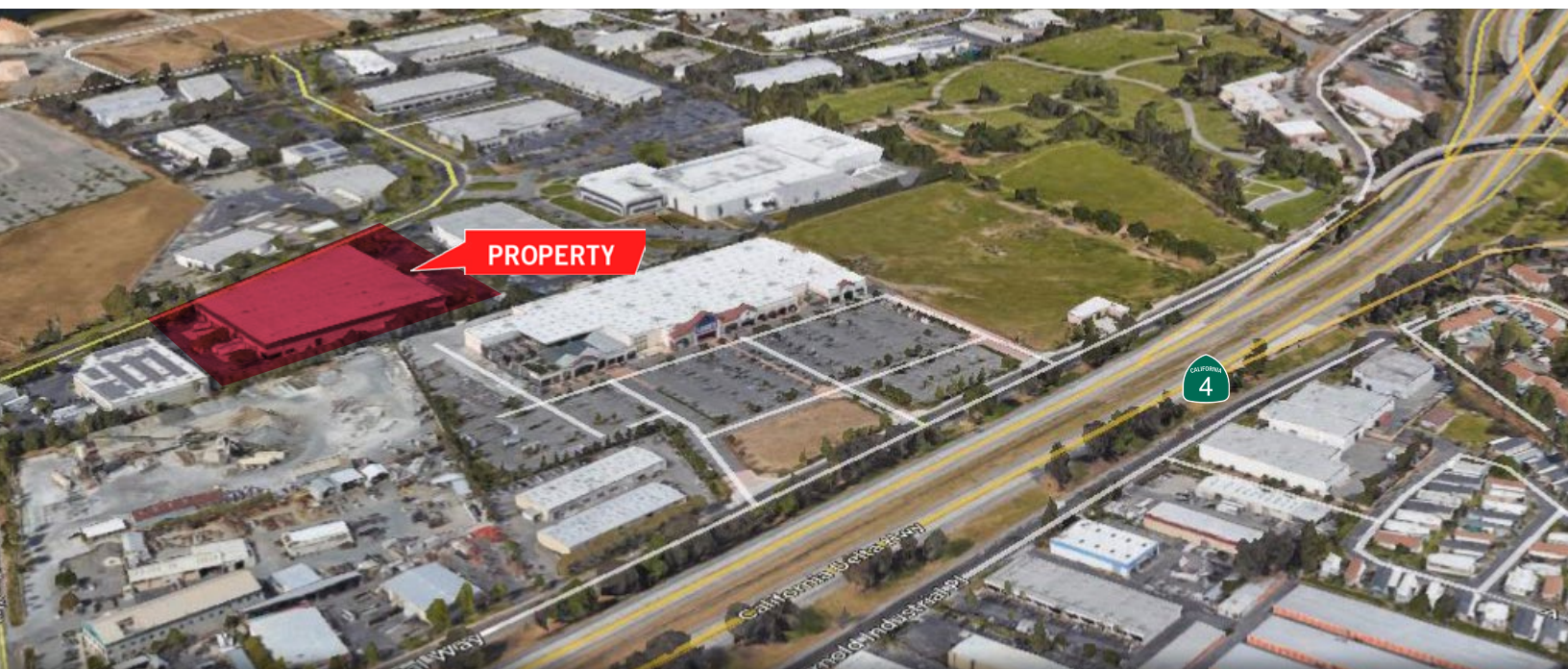
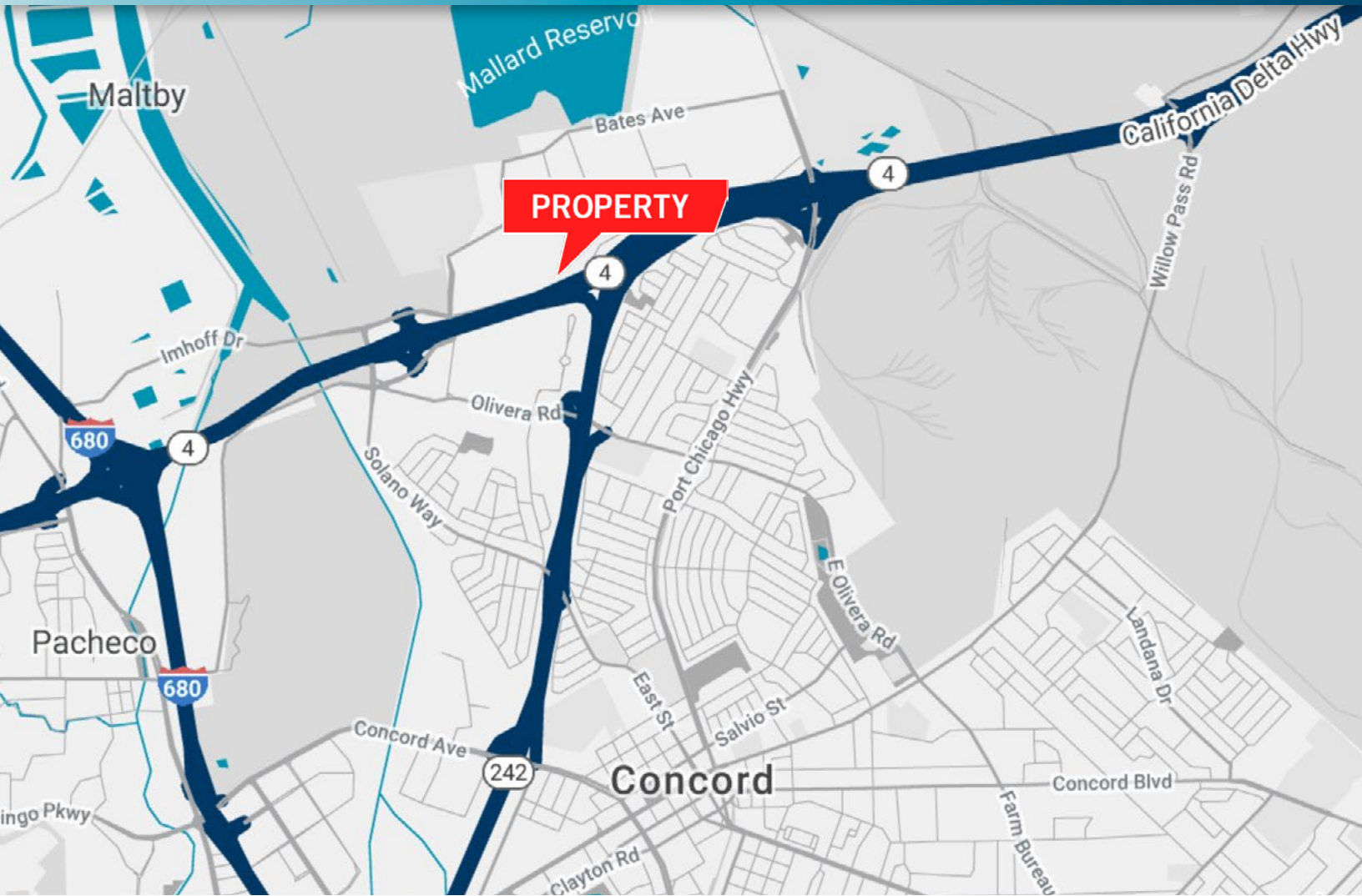

**Tony Binswanger, SIOR**  
Executive Director  
+1 925 627 2482  
Tony.Binswanger@cushwake.com  
LIC#01861701

**Bo Harkins**  
Director  
+1 925 627 2481  
bo.harkins@cushwake.com  
LIC #01943785

