

INDUSTRIAL FOR LEASE



716 S 17th Street, Wilmington, NC 28401



OFFERING SUMMARY

AVAILABLE SF:	1,686 SF
LEASE RATE:	\$2,500 per month (Net)
LOT SIZE:	0.25 Acres
YEAR BUILT:	1945
BUILDING SIZE:	10,125 SF
ZONING:	Urban Multi-Use

PROPERTY OVERVIEW

OPPORTUNITY! This urban mix use industrial space is perfect for a number of uses including retail, bottle shop, brewery or office. Excellent facility with divided occupied lease spaces.

Comprised of 1,686 SF at street level on S. 17th Street, minutes from the newly named "Cargo District". The exterior is painted brick with space for signage and a store front display.

PROPERTY HIGHLIGHTS

- Great location in up and coming newly named Cargo District
- Storefront located on S. 17th Street
- Large storefront display windows
- 30 ft ceilings
- Flexible spaced facility

KW COMMERCIAL
1001 Military Cutoff Rd,
Suite 100
Wilmington, NC 28405

CHRISTIAN CARDAMONE
Broker | General Contractor
O 910.777.2200
C 910.262.3399
christiancardamone@kw.com

We obtained the information above from sources we believe to be reliable. However, we have not verified its accuracy and make no guarantee, warranty or representation about it. It is submitted subject to the possibility of errors, omissions, change of price, rental or other conditions, prior sale, lease or financing, or withdrawal without notice. We include projections, opinions, assumptions or estimates for example only, and they may not represent current or future performance of the property. You and your tax and legal advisors should conduct your own investigation of the property and transaction.

INDUSTRIAL FOR LEASE

716 S 17th Street, Wilmington, NC 28401

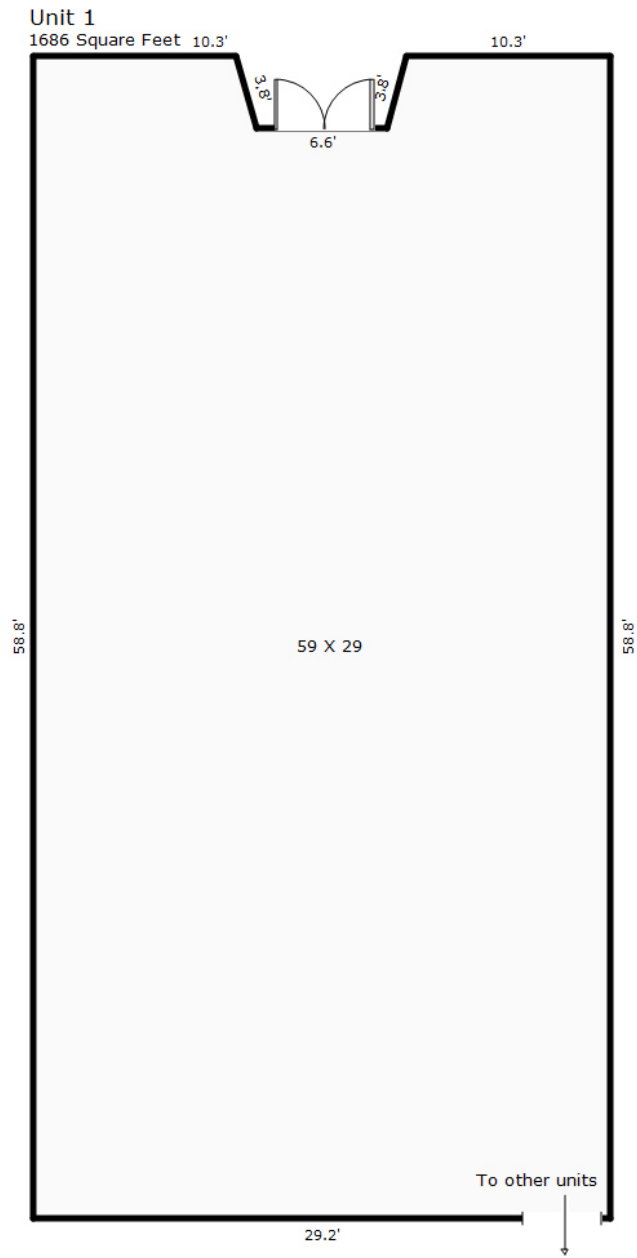

KW COMMERCIAL
1001 Military Cutoff Rd,
Suite 100
Wilmington, NC 28405

CHRISTIAN CARDAMONE
Broker | General Contractor
O 910.777.2200
C 910.262.3399
christiancardamone@kw.com

We obtained the information above from sources we believe to be reliable. However, we have not verified its accuracy and make no guarantee, warranty or representation about it. It is submitted subject to the possibility of errors, omissions, change of price, rental or other conditions, prior sale, lease or financing, or withdrawal without notice. We include projections, opinions, assumptions or estimates for example only, and they may not represent current or future performance of the property. You and your tax and legal advisors should conduct your own investigation of the property and transaction.

INDUSTRIAL FOR LEASE



716 S 17th Street, Wilmington, NC 28401

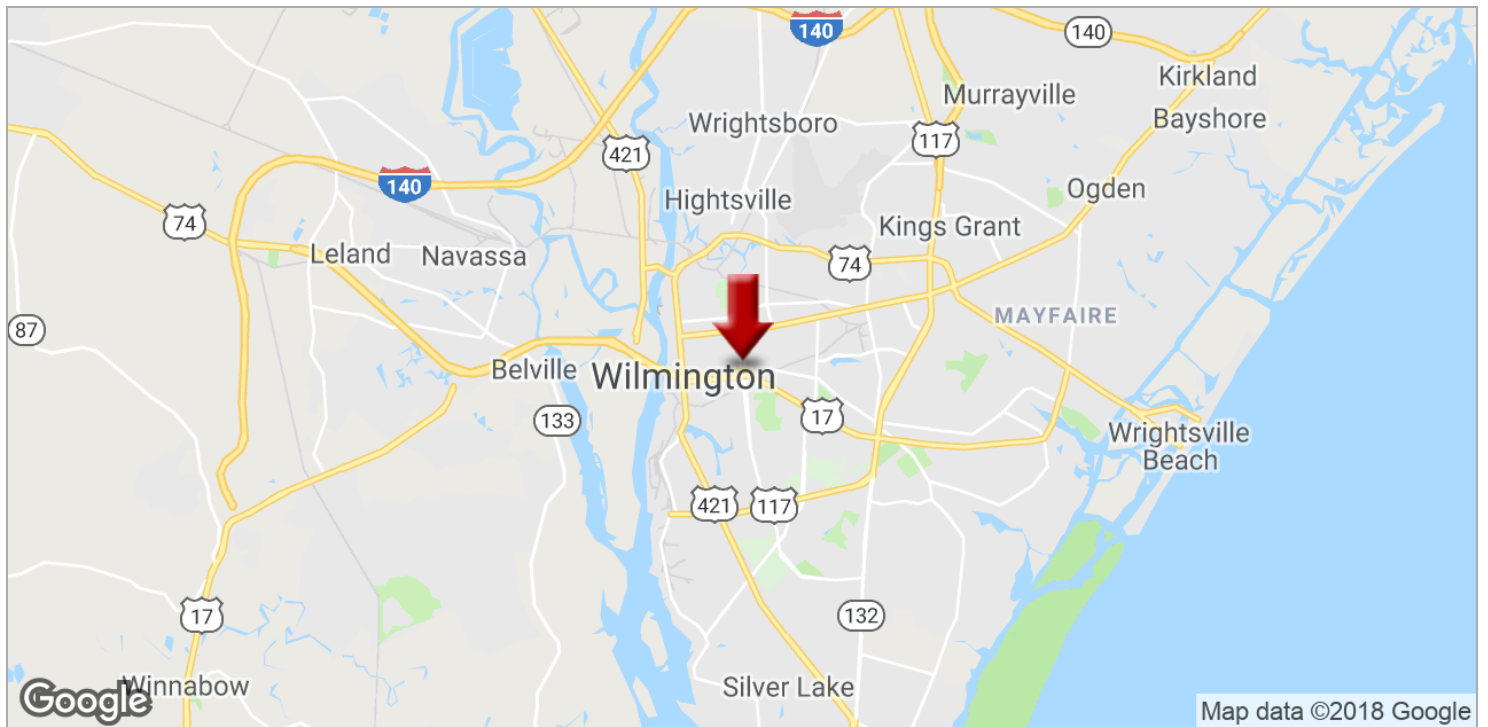
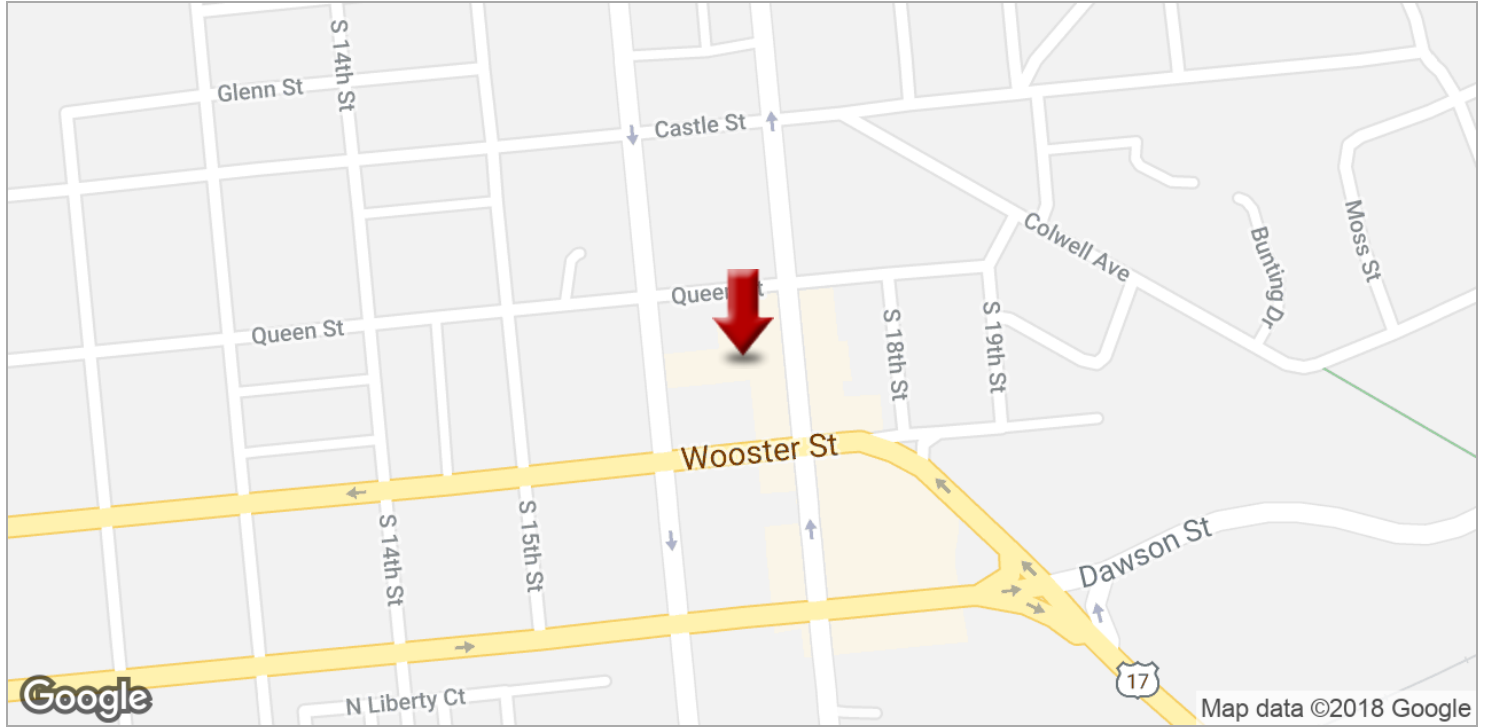

KW COMMERCIAL
1001 Military Cutoff Rd,
Suite 100
Wilmington, NC 28405

CHRISTIAN CARDAMONE
Broker | General Contractor
O 910.777.2200
C 910.262.3399
christiancardamone@kw.com

We obtained the information above from sources we believe to be reliable. However, we have not verified its accuracy and make no guarantee, warranty or representation about it. It is submitted subject to the possibility of errors, omissions, change of price, rental or other conditions, prior sale, lease or financing, or withdrawal without notice. We include projections, opinions, assumptions or estimates for example only, and they may not represent current or future performance of the property. You and your tax and legal advisors should conduct your own investigation of the property and transaction.